

STATE INDEX

TRACT REGISTER OF ACQUISITION AFTER 1, JAN. 1943

| AUTH.    | TRACT NO. | LAND OWNER                            | ACREAGE |       |        |        |         | REMARKS                                 |
|----------|-----------|---------------------------------------|---------|-------|--------|--------|---------|---|
|          |           |                                       | FEE     | EASMT | PERMIT | TRANS. | LICENSE |   |
| DM NO. 9 | 400       | ALVA W. & MARGARET MERCER             | 161.11  |       |        |        |         |   |
| "        | 401       | GEORGE LEE DILTZ                      | 5.21    |       |        |        |         |   |
| DM NO. 5 | 402       | MARGERY DIXON                         | 3.60    |       |        |        |         |   |
| "        | 403       | HOMER & GRACE ERSKINE                 | 83.35   |       |        |        |         |   |
| "        | 403E      | HOMER & GRACE ERSKINE                 |         | 0.18  |        |        |         | PERPETUAL EASEMENT FOR HIGHWAY PURPOSES |
| "        | 404       | GEORGE LEE DILTZ                      | 105.00  |       |        |        |         |   |
| "        | 406       | HOMER L. SWIFT, ET UX                 | 5.54    |       |        |        |         |   |
| DM NO. 9 | 407E-1    | WILLIAM LAWRIE, ET UX                 |         | 0.22  |        |        |         |   |
| "        | 407E-2    | WILLIAM LAWRIE, ET UX                 |         | 0.34  |        |        |         |   |
| DM NO. 5 | 408       | ARTHUR PHILLIP SMITH & JORNA K. SMITH | 40.94   |       |        |        |         |   |
| DM NO. 9 | 409E      | R.B. & MARTHA E. WALKER               |         | 0.62  |        |        |         |   |
| DM NO. 5 | 411       | GORDON ARNOTT, ET AL                  | 113.42  |       |        |        |         |   |
| DM NO. 9 | 412       | WENDELL SHAFFER                       | 230.77  |       |        |        |         |   |

PRELIMINARY

PROJECT MAP

DEPT. OF THE ARMY  
 USING SERVICE CORPS OF ENGINEERS  
 LOCATION OF PROJECT  
 STATE OHIO  
 COUNTY FAYETTE, HIGHLAND, & ROSS  
 DIVISION OHIO RIVER  
 DISTRICT HUNTINGTON  
 ARMY AREA 2 ND  
 50 MILES SW OF COLUMBUS  
 22 MILES W OF CHILLICOTHE

TRANSPORTATION FACILITIES

RAILROADS  
 STATE ROADS 138, 41, 753, 8, 28  
 FEDERAL ROADS 50  
 AIR LINES

ACQUISITION

TOTAL ACRES ACQUIRED  
 FEE \_\_\_\_\_  
 PUBLIC DOMAIN { WITHDRAWAL \_\_\_\_\_  
 { USE PERMIT \_\_\_\_\_  
 USE PERMIT (OTHER THAN P. D.) \_\_\_\_\_  
 TRANSFER { \_\_\_\_\_  
 LEASE \_\_\_\_\_  
 LESSER INTERESTS { SEE SEGMENT \_\_\_\_\_

DISPOSAL

TOTAL ACRES DISPOSED OF  
 SOLD \_\_\_\_\_  
 PUBLIC DOMAIN { WITHDRAWAL \_\_\_\_\_  
 { USE PERMIT \_\_\_\_\_  
 USE PERMIT (OTHER THAN P. D.) \_\_\_\_\_  
 TRANSFERRED { \_\_\_\_\_  
 LEASES TERMINATED \_\_\_\_\_  
 LESSER INTERESTS TERM. \_\_\_\_\_  
 REASSIGNED \_\_\_\_\_  
 OTHER \_\_\_\_\_

LEGEND

EXCEPT FOR THE SPECIAL SYMBOLS SHOWN BELOW MAP SYMBOLS ARE STANDARD IN ARMY MAP SERVICE TECHNICAL MANUAL NO. 23.

- RESERVATION LINE \_\_\_\_\_
- RESERVATION LINE (Actual Survey) \_\_\_\_\_
- TRACT BOUNDARY LINE \_\_\_\_\_
- TRACT NUMBER \_\_\_\_\_
- CONTOUR LINE \_\_\_\_\_
- INTERIOR FEE TAKING LINE \_\_\_\_\_
- EXTENDED OWNERSHIP LINE \_\_\_\_\_

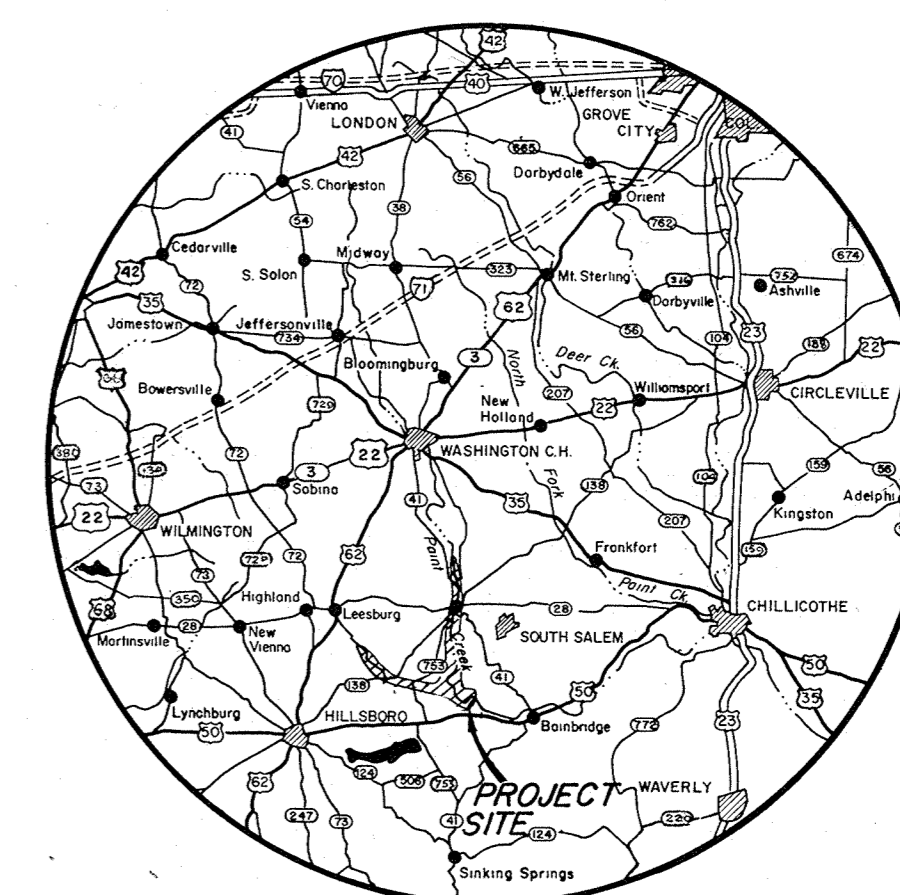

SEGMENT 5

SEGMENT 3

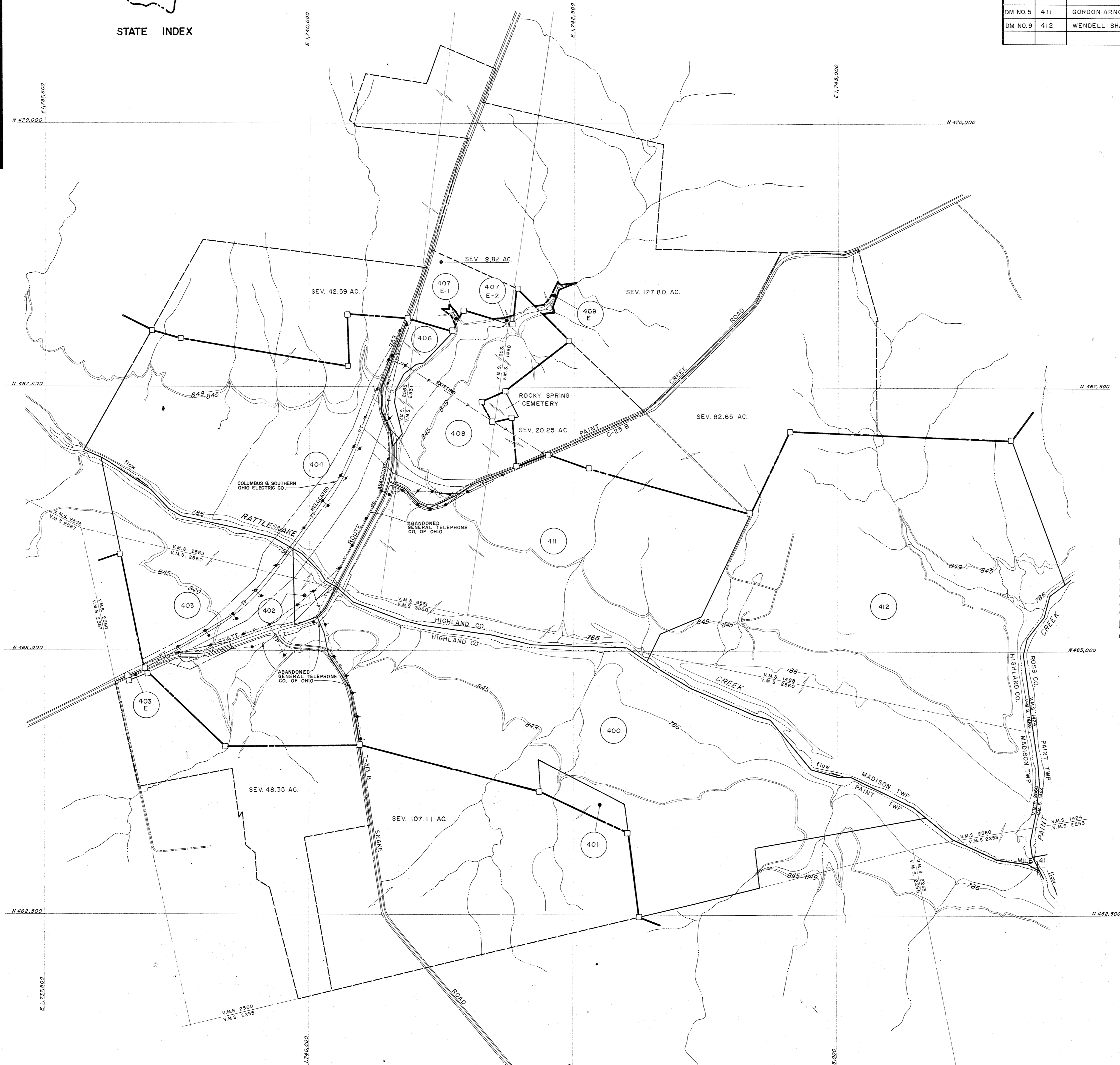

NOTES

- RELOCATED ● RELOCATED TELEPHONE LINE
- ABANDONED ● ABANDONED TELEPHONE LINE
- EXISTING ● EXISTING TELEPHONE LINE
- RELOCATED ● RELOCATED POWER LINE
- ABANDONED ● ABANDONED POWER LINE
- EXISTING ● EXISTING POWER LINE

The boundary of this project was compiled from deed descriptions, and aerial surveys, etc.

This map is drawn on the Ohio State Plane Coordinate System, South Zone.

The aerial photography, ground control and mapping of the land depicted on this sheet was performed by Berger Associates, Ltd., Columbus, Ohio, under Contract No. DA-46-022-CIV-ENG-63-498

Tract numbers having "E" suffix denotes usual type perpetual flowage easements unless otherwise specified.

- CONTOUR LEGEND
- 849 Guide Taking Contour
  - 845 Maximum Flood Control Pool
  - 786 Permanent Pool

ACQUISITION AUTHORIZATION

ENR-AP 2nd Ed. dated 24 September 1965 (D. M. No. 8)  
 ENR-AP 2nd Ed. dated 30 June 1966 (D. M. No. 9)

DRAWN BY JOSEPH SMITH  
 TRACED BY JOSEPH SMITH  
 CHECKED BY BEN HOOF

SUBMITTED BY  
*Joseph Smith*  
 CHIEF, PLANNING & CONTROL, ...

RECOMMENDED BY  
*Ben Hoof*  
 COL, CORPS OF ENGINEERS, DISTRICT ENGINEER

APPROVED BY  
*Joseph Smith*  
 COL, CORPS OF ENGINEERS, DISTRICT ENGINEER

OFFICE, CHIEF OF ENGINEERS, WASHINGTON 25, D. C. DATE AUGUST 1965

SCALE IN FEET  
 500 0 500 1000  
 SHEET 4 OF 12 DRAWING NO.

| MICROFILMED | DATE | REVISIONS | BY |
|-------------|------|-----------|----|
|             |      |           |    |
|             |      |           |    |
|             |      |           |    |