

TRACT REGISTER OF ACQUISITION AFTER 1, JAN. 1943

AUTH.	TRACT NO.	LAND OWNER	ACREAGE					REMARKS
			FEE	EASMT	PERMIT	TRANS.	LICENSE	
DM NO. 9	300	C. RALPH CUMMINGS	365.63					
"	301	ESTHER C. CLYBURN, ET VIR	17.62					
DM NO. 9	303	DONALD R. & CAROLYN S. MURDOCK	121.82					
"	304	FANNY M. BROOKOVER	158.82					
"	305	DOROTHY A. MC CLOSKEY	19.60					
"	306	HERMAN D. TAYLOR	0.51					
DM NO. 9	307	JOSEPH D. FLYNN & WENDELL SHAFER	96.40					
"	308	HERMAN D. TAYLOR, ET UX	11.87					
"	309	CHARLES H. & BETTY F. TAYLOR	87.72					
"	310	JOSEPH D. FLYNN	236.85					
"	311	HERMAN D. TAYLOR & MORIE TAYLOR	10.08					
DM NO. 9	312	JACK B. DREHER	96.45					
"	313	CHESTER A. COCKERILL	120.83					
"	314	E.M. HALL	62.19					

PRELIMINARY

PROJECT MAP

DEPT. OF THE ARMY
 USING SERVICE CORPS OF ENGINEERS
LOCATION OF PROJECT
 STATE OHIO
 COUNTY FAYETTE, HIGHLAND, & ROSS
 DIVISION OHIO RIVER
 DISTRICT HUNTINGTON
 ARMY AREA I ST
 50 MILES SW OF COLUMBUS
 22 MILES W OF CHILLICOTHE

TRANSPORTATION FACILITIES

RAILROADS
 STATE ROADS 138, 41, 753, & 28
 FEDERAL ROADS 50
 AIR LINES

ACQUISITION

TOTAL ACRES ACQUIRED
 FEE _____
 PUBLIC DOMAIN { WITHDRAWAL _____
 { USE PERMIT _____
 USE PERMIT (OTHER THAN P. D.) _____
 TRANSFER { _____
 LEASE _____
 LESSER INTERESTS { SEE SEGMENT _____

DISPOSAL

TOTAL ACRES DISPOSED OF
 SOLD _____
 PUBLIC DOMAIN { WITHDRAWAL _____
 { USE PERMIT _____
 USE PERMIT (OTHER THAN P. D.) _____
 TRANSFERRED { _____
 LEASES TERMINATED _____
 LESSER INTERESTS TERM. _____
 REASSIGNED _____
 OTHER _____

LEGEND

EXCEPT FOR THE SPECIAL SYMBOLS SHOWN BELOW MAP SYMBOLS ARE STANDARD IN ARMY MAP SERVICE TECHNICAL MANUAL NO. 23.

- RESERVATION LINE _____
- RESERVATION LINE (Actual Survey) _____
- TRACT BOUNDARY LINE _____
- TRACT NUMBER _____
- CONTOUR LINE _____
- DISPOSAL _____
- EXTENDED OWNERSHIP LINE _____

SEGMENT 3

DEPARTMENT OF THE ARMY
 ENGINEER DISTRICT HUNTINGTON
 CORPS OF ENGINEERS
 OHIO RIVER DIVISION

REAL ESTATE

PAINT CREEK LAKE

DRAWN BY JOHN SPENCER
 TRACED BY JOHN SPENCER
 CHECKED BY BEN HOOFF
 SUBMITTED BY
W. J. Spencer
 CHIEF, PLANNING & CONTROL, SR
 RECOMMENDED BY
J. P. Rogers
 COL, CORPS OF ENGINEERS, DISTRICT ENGINEER
 OFFICE, CHIEF OF ENGINEERS, WASHINGTON 25, D. C.
 APPROVED BY
W. J. Spencer
 DATE MAY 1966

SCALE IN FEET
 500 0 500 1000
 SHEET 3 OF 12 DRAWING NO.

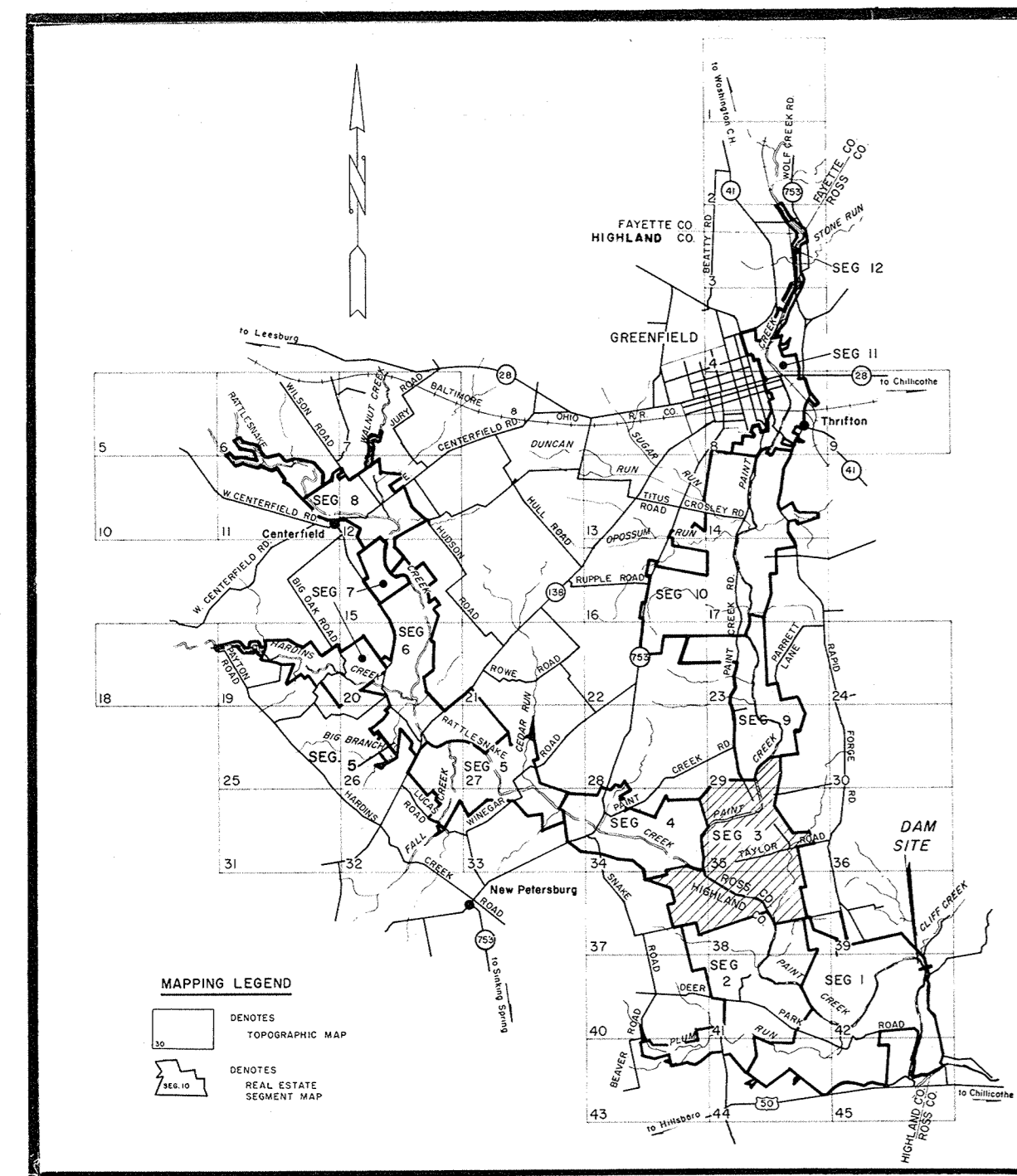

SEGMENT MAP INDEX
ONE INCH EQUALS APPROXIMATELY 2 MILES

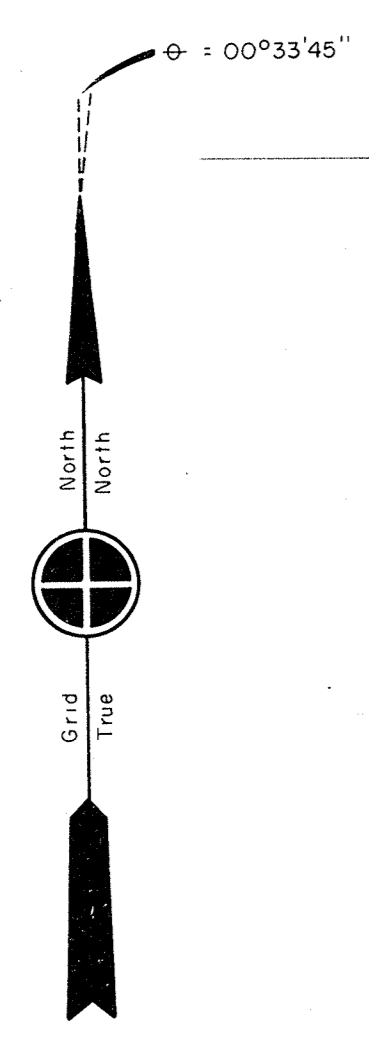

SEGMENT 4

SEGMENT 9

STATE INDEX

SEGMENT 2

SEGMENT 1

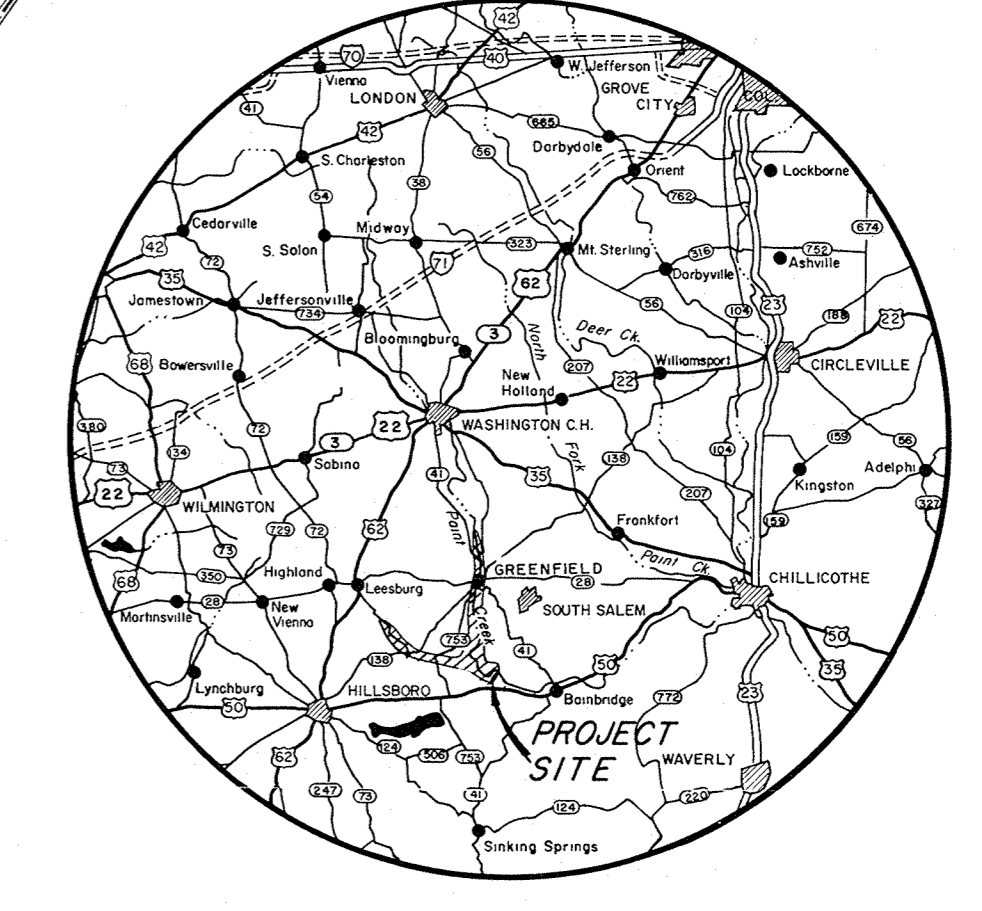

VICINITY MAP
SCALE IN MILES

NOTES
 The boundary of this project was compiled from deed descriptions, and aerial surveys, etc.
 This map is drawn on the Ohio State Plane Coordinate System, South Zone.
 The aerial photography, ground control and mapping of the land depicted on this sheet was performed by Berger Associates, Ltd., Columbus, Ohio, under Contract No. DA-46-022-C-1VENG-63-498.
 Tract numbers having "E" suffix denotes usual type perpetual flowage easements unless otherwise specified.

CONTOUR LEGEND
 849 Guide Taking Contour
 845 Maximum Flood Control Pool
 786 Permanent Pool

MICROFILMED	DATE	REVISIONS	BY